

- NOTES
1. NO DIMENSIONS TO BE SCALED FROM THIS DRAWING.
  2. THIS DRAWING TO BE READ WITH ALL RELEVANT ARCHITECTS, ENGINEERS AND SPECIALISTS DRAWINGS.
  3. ALL STRUCTURAL STEELWORK TO BE GRADE S275 TO EN 10025 UNLESS OTHERWISE STATED.
  4. ALL BOLTS TO BE 8.8 GRADE BLACK BOLTS IN 2 mm CLEARANCE HOLES UNLESS OTHERWISE STATED.
  5. ALL BRICKWORK TO BE MINIMUM 21 N/mm<sup>2</sup> IN NHL 3.5 MORTAR UNLESS OTHERWISE STATED.
  6. ALL STEELWORK TO BE GALVANISED AND PAINTED IN ACCORDANCE WITH THE SPECIFICATION.
  7. ALL SETTING OUT AND SITE DIMENSIONS TO BE THE RESPONSIBILITY OF THE CONTRACTOR.
  8. DESIGN AND INSTALLATION OF TEMPORARY WORKS TO BE THE RESPONSIBILITY OF THE CONTRACTOR.
  9. ALL NEW STRUCTURAL TIMBER TO BE C24 SAWN TREATED SOFTWOOD UNLESS OTHERWISE STATED.
  10. ALL STAINLESS STEEL TO BE GRADE 316 AUSTENITIC UNLESS OTHERWISE STATED.
  11. ALL CLIENTS' STAFF, CONSULTANTS, AND CONTRACTORS MUST COMPLY WITH ALL CURRENT HEALTH AND SAFETY LEGISLATION INCLUDING:
    - a. CONSTRUCTION (DESIGN & MANAGEMENT) REGULATIONS 2015
    - b. HEALTH & SAFETY AT WORK ACT 1974
    - AND ALL OTHER RELEVANT LEGISLATION
  12. ALL WORK TO BE CARRIED OUT IN ACCORDANCE WITH THE PROJECT HEALTH AND SAFETY FILE AND METHOD STATEMENTS.
  13. ALL WORK ELEMENTS TO BE CARRIED OUT USING APPROPRIATE TOOLS, METHODS, MATERIALS AND TECHNIQUES.
  14. HOLES IN EXISTING MASONRY TO BE DRILLED WITH NON-PERCUSSIVE DIAMOND TIPPED DRILLS USING THE MINIMUM WATER POSSIBLE FOR LUBRICATION.
  15. STRUCTURAL FIXINGS TO EXISTING MASONRY TO BE WITH FISCHER FS V EPOXY MORTAR UNLESS OTHERWISE STATED.
  16. ALL WORK TO SENSITIVE HISTORIC FABRIC TO BE CARRIED OUT BY SUITABLY EXPERIENCED AND SKILLED PERSONNEL.
  17. NO OPENING UP BEYOND THAT INDICATED ON THE DRAWINGS TO BE CARRIED OUT WITH OUT PRIOR PERMISSION.
  18. THE DRAWINGS AND DETAILS ARE PREPARED USING THE INFORMATION AVAILABLE AND MAY BE AT VARIANCE WITH HIDDEN HISTORIC FABRIC. REPORT ANY VARIATIONS OR DIFFERENCES FOUND DURING THE WORK TO THE ARCHITECT AND ENGINEER.
  19. CONCRETE TO BE RC35 UNLESS OTHERWISE STATED.
  20. REINFORCEMENT TO BE HIGH YIELD TYPE B BARS UNLESS OTHERWISE STATED.
  21. ALL NEW MASONRY TO BE FULLY BRICK BONDED TO EXISTING UNLESS OTHERWISE STATED.
  22. ALL WELDS TO BE 6 mm CONTINUOUS FILLET WELDS UNLESS OTHERWISE STATED.
  23. ALL SCAFFOLD TO COMPLY WITH HASE TO20:21 WITH NO SEASONAL OR STATISTICAL REDUCTIONS TO WIND LOAD.
  24. ALL CONNECTIONS TO BE DESIGNED AND DETAILED BY THE CONTRACTOR UNLESS STATED OTHERWISE.

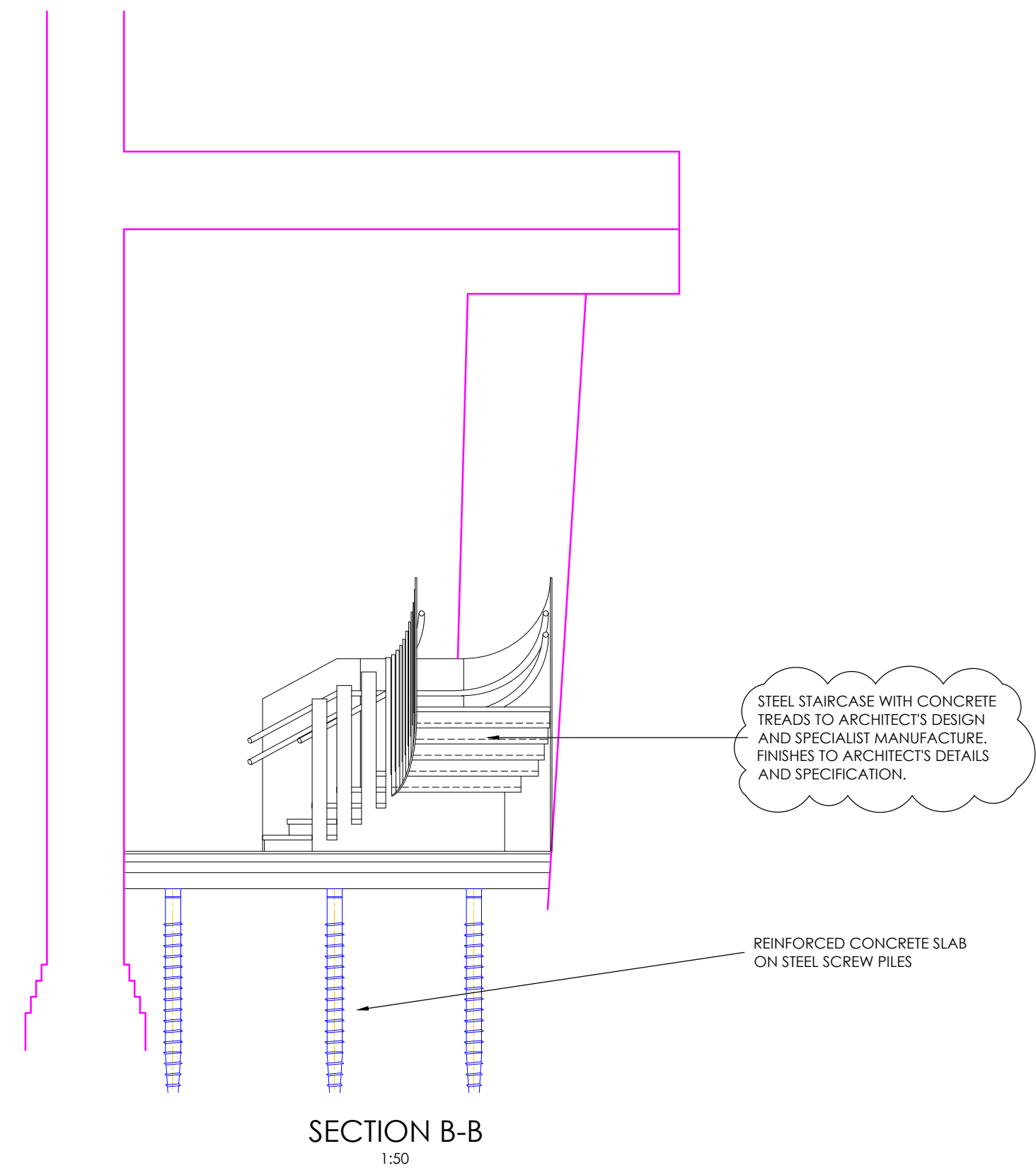
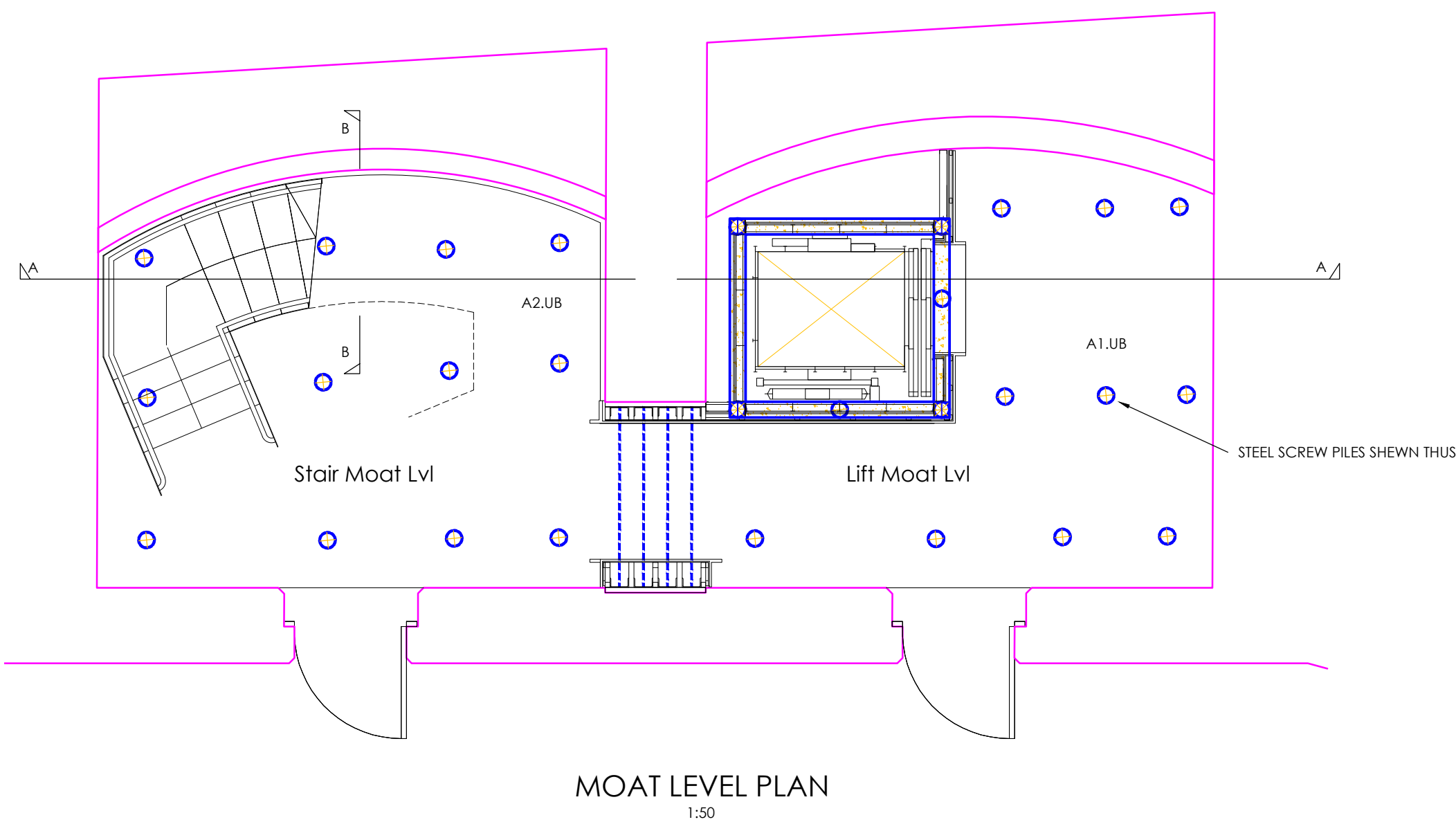
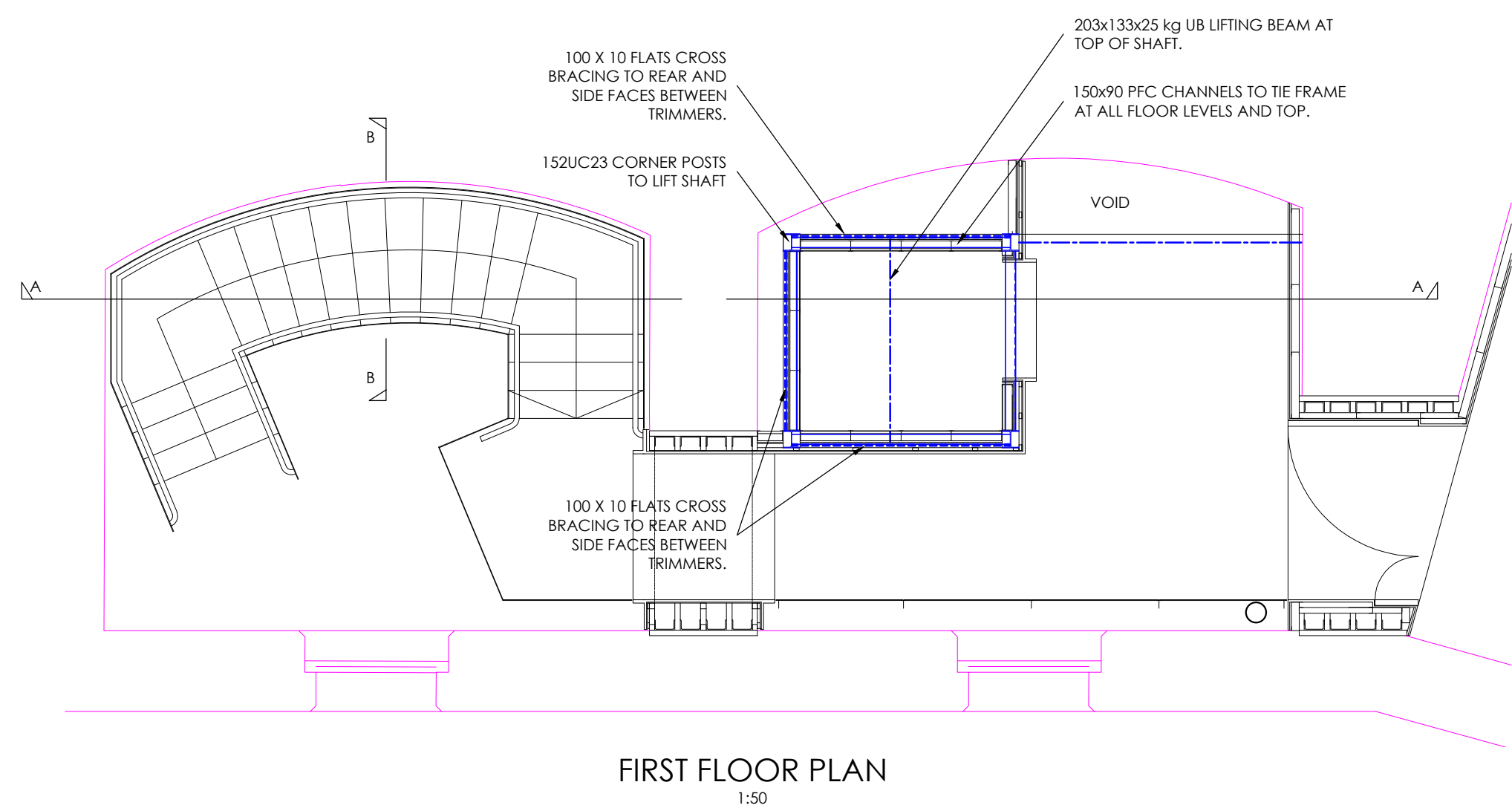
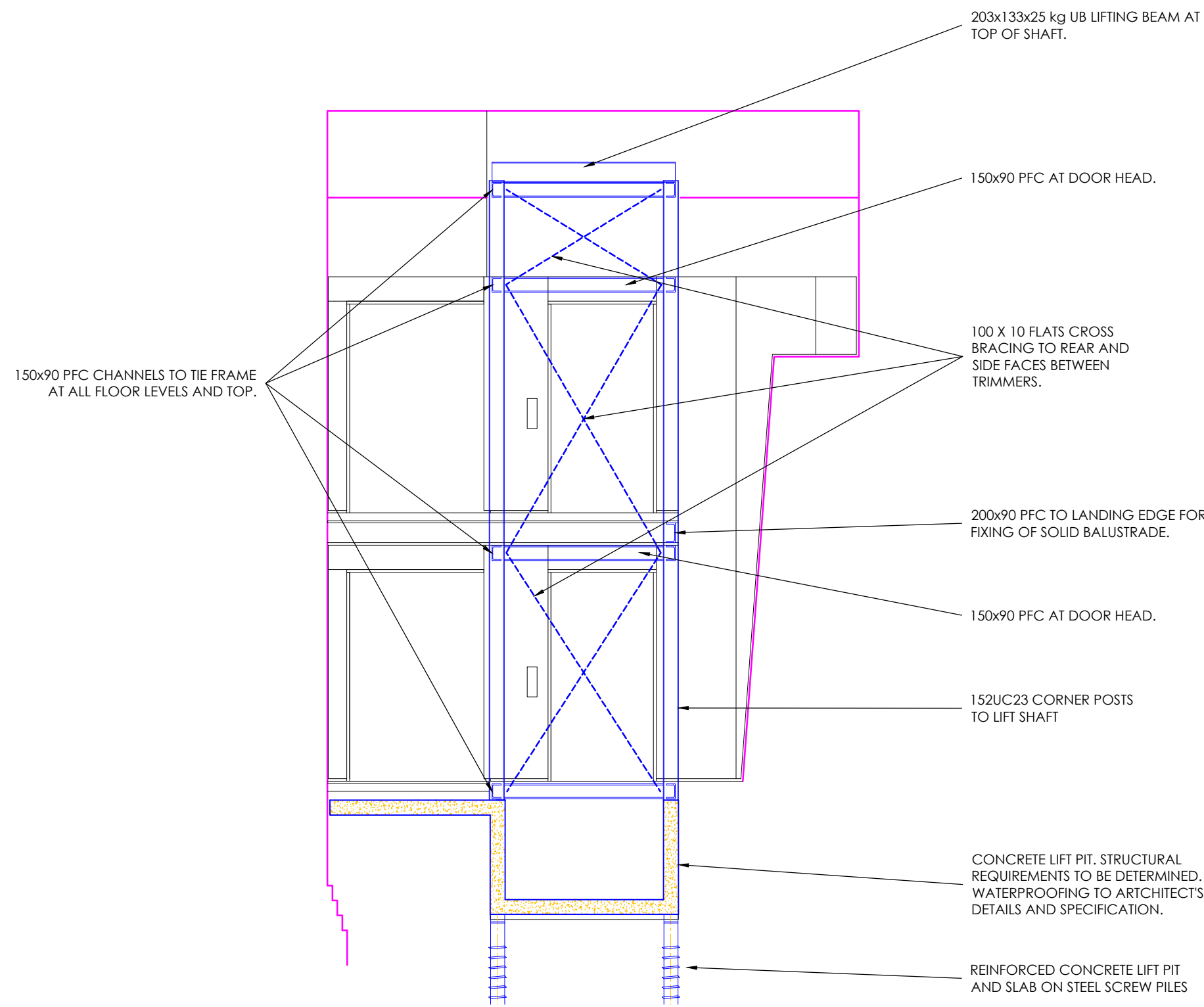
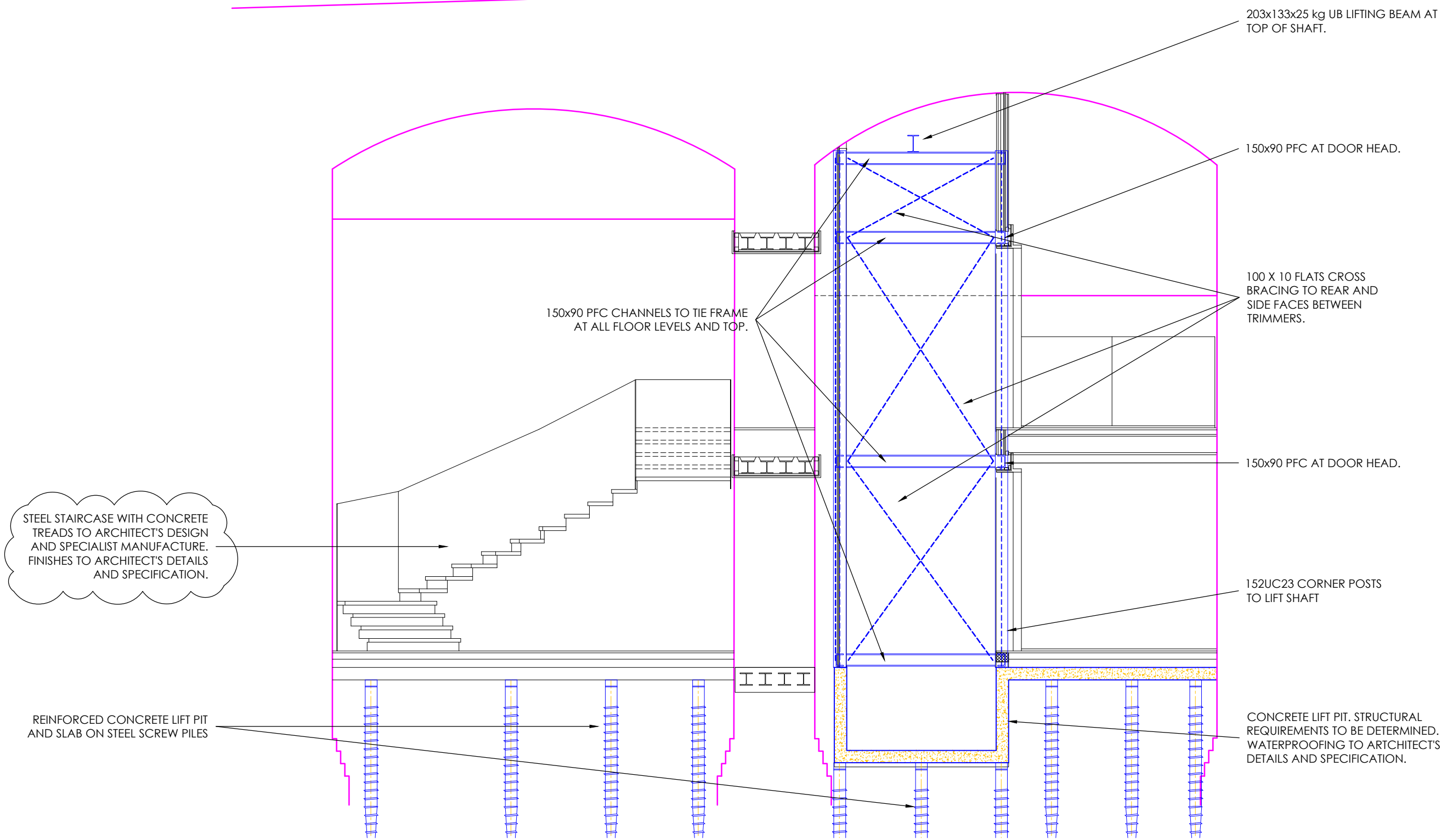

STAGE 4B ISSUE

rev	description	date
<b>Hockley &amp; Dawson</b> Consulting Engineers Hockley & Dawson Consulting Engineers Limited  Telephone 01483 548784 admin@hockleyanddawson.co.uk www.hockleyanddawson.co.uk  5 Birtley Courtyard Bramley Surrey GU5 0LA		
project PERKIN REVELLER TOWER OF LONDON  Historic Royal Palaces		
drawing title STRUCTURAL SCHEME DETAILS - LIFT FRAME R I B A   S T A G E   4   B © COPYRIGHT		
Drawn CJD	Checked CJD	
Date July 2025	Scale As stated at A1	
Job No <b>21996</b>	Dwg No <b>1 11</b>	Rev -